

B TELECOM CONDUIT DETAIL

TELECOM DUCT INSTALLATION SPECIFICATIONS

1. TOP OF CONDUIT SHALL BE PLACED NO LESS THAN 18'-2 1/4" BELOW FINISHED GRADE
2. PLACE 6" WIDE YELLOW FIBER OPTIC CABLE MARKING TAPE NO GREATER THAN 5" BELOW FINISH GRADE
3. CONCRETE DUCT BANK CAPPING SHALL BE RED-PIGMENTED CONCRETE FOR LANDSCAPE-EXPOSED SECTIONS.
4. DEPTH OF CONCRETE CAP SHALL BE NO LESS THAN 15" BELOW FINISHED GRADE
5. LENGTH OF CONDUIT SHALL BE 3' MINIMUM BEYOND BUILDING FOOTING
6. ALL CONDUITS SHALL BE PLUGGED AND/OR CAPPED
7. IF MORE THAN (2) LARGE RADIIUS 90 DEGREE BENDS ARE REQUIRED, AN INTERMEDIATE PULL BOX IS REQUIRED
8. ALL BENDS SHALL MAINTAIN A MIN. 48" BEND RADIUS
9. WITH A BINDER/VACUUM AND MEASURE EACH CONDUIT AND INNERDUCT
10. EACH 4" CONDUIT SHALL HAVE A 5/8" 1,800 LB TENSILE STRENGTH, PRELUBRICATED, FOOTAGE-MARKED POLYESTER PULL TAPE. EACH MULTI-GANG DUCT SHALL HAVE A 1/2" 1,250 LB TENSILE STRENGTH, PRELUBRICATED, FOOTAGE-MARKED POLYESTER PULL TAPE.
11. 3/4" AGGREGATE SHALL BE INSTALLED IN BOTTOM OF CONDUIT TRENCH, DUCTBANK
12. A METALLIC TRACER WIRE SHALL BE INSTALLED 6' - 8' BELOW GRADE.
13. ALL MULTI-GANG SUB-DUCTS SHALL BE PRE-LUBRICATED ACCORDING TO BELL CORE GR356-CORE REQUIREMENTS.
14. ALL CONDUIT SHALL ENTER MANHOLE AT 90DEGREE ANGLES.

TELECOM DUCT SPECIFICATIONS

1. ALL CONDUITS AND DUCT ACCESSORIES SHALL BE INSTALLED ACCORDING TO THE MANUFACTURER'S RECOMMENDED INSTALLATION GUIDELINES.
2. ALL CONDUIT ACCESSORIES, AND COMPONENTS SHALL BE CARLON SCHEDULE 40 UL LISTED FOR UNDERGROUND USE WITH FIBER OPTICS AND COMMUNICATIONS CABLE.
3. ALL MULTI-GANG CONDUIT SHALL BE CARLON CMF5345-020 OR EQUIVALENT. ALL MULTI-GANG 4" SUB-DUCTS SHALL BE CARLON CMF5345-020 OR EQUIVALENT.
4. ALL CONDUIT SHALL BE RACKED WITHIN THE TRENCH.
5. ALL DUCTS SHALL BE RACKED WITHIN THE TRENCH.

TELECOM MANHOLE SPECIFICATIONS

1. MANHOLE SPECIFICATION SHALL BE AN LUDCASTLE PRECAST DOUBLE LEAF 3'-0" WIDE x 5'-0" LONG x 3'-0" OR APPROVED APPROVED EQUAL. COVER SHALL BE HINGED. ALL KNOCKOUT SIZES AND CONFIGURATIONS SHALL BE COORDINATED WITH THE MANUFACTURER PRIOR TO ORDER
2. INSTALLED CONDUIT KNOCK-OUTS AND VIDS AROUND CONDUITS SHALL BE SEALED PIST CONDUIT INSTALLATION.
3. ALL HANDHOLES TO BE INSTALLED WITH CABLE RACKING HARDWARE.
4. ALL CONDUIT ENTRANCES SHALL UTILIZE OLD CASTLE HDPE TERMINATORS OR APPROVED EQUAL.
5. HAND-HOLES SHALL BE INSTALLED LEVEL AND TOP ENTRANCE DODGERS SHALL BE FLUSH WITH FINISHED GRADE. BE INSTALLED ON DIVERS PROPERTY.
6. MANHOLES SHALL BE EQUIPPED WITH SUMP AND/OR DRAINAGE FIELD TO ELIMINATE STANDING WATER
7. ALL CONDUIT IN MANHOLE SHALL BE STOPPED AND SEALED

C TELECOM SITE PLAN NOTES

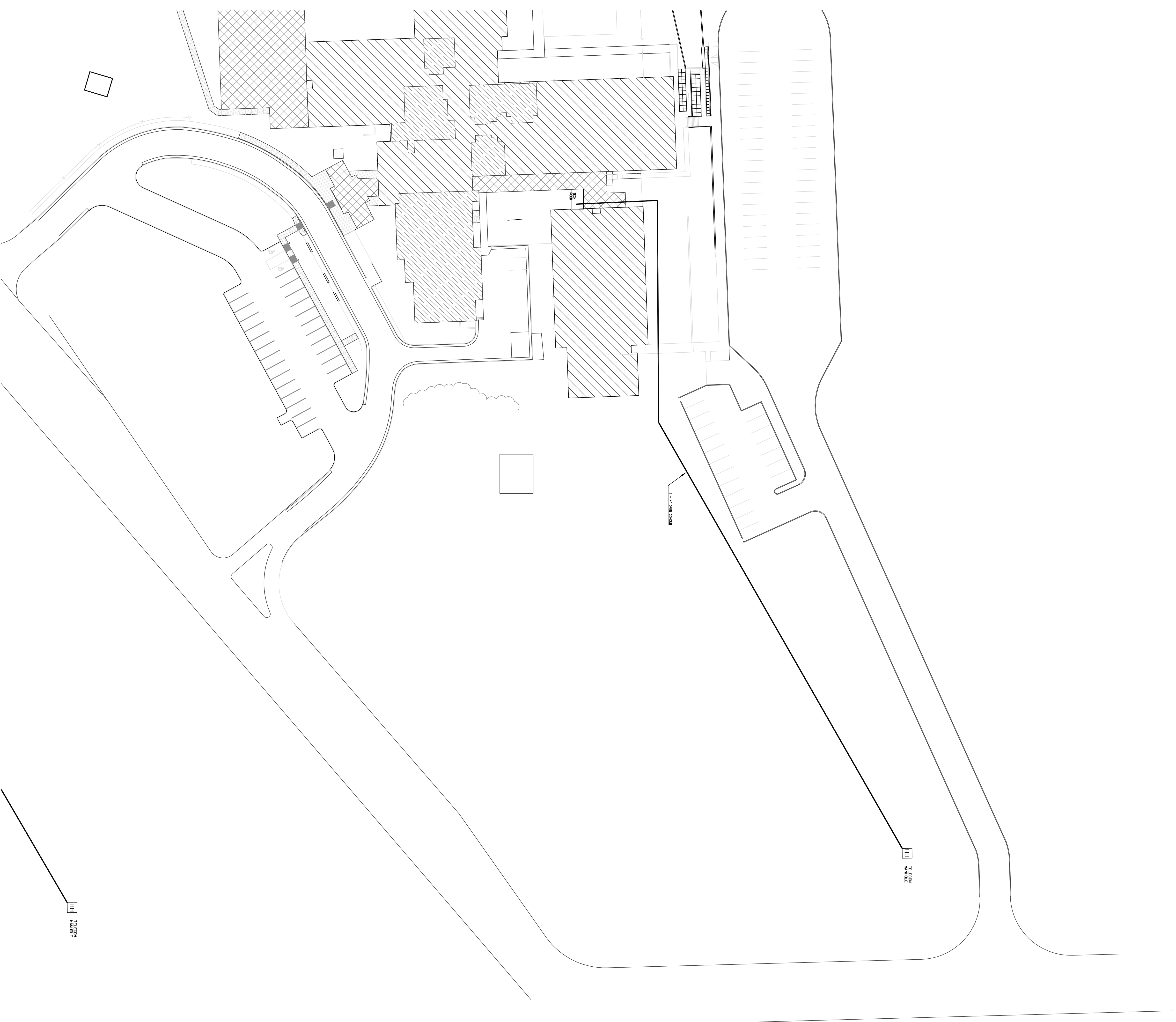

A SITE PLAN

STRAVIS TECHNOLOGIES

4506 Ecorse Parkway Suite 300
 Addison, TX 75001
 972.644.9822

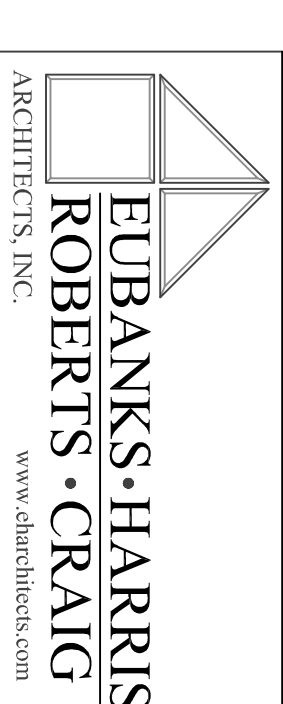
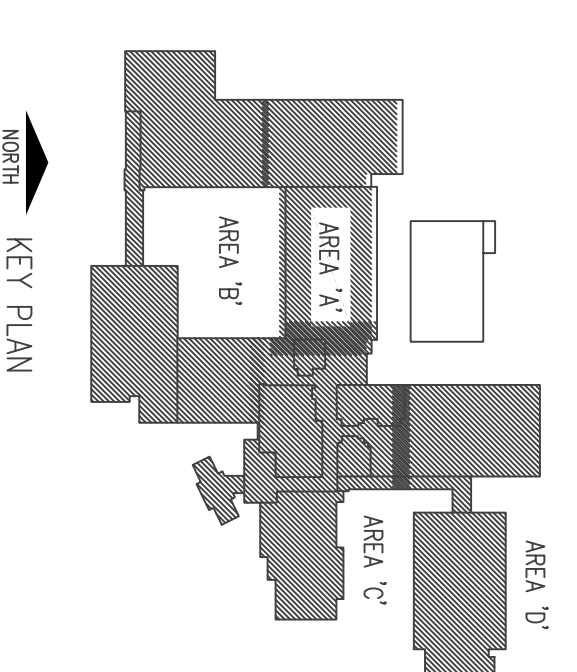

FOR CONSTRUCTION
 DATE: 02-23-2010

6530 NEW CORNELIUS RD.
 TYLER, TEXAS 75703
 PHONE: 903-534-0995
 FAX: 903-534-1071

OWENS ELEMENTARY
 TYLER I.S.D.
 TYLER, TEXAS

DRAWING: TECHNOLOGY SITE PLAN
 SHEET NO.: 11.0
 DATE: 02-23-2010