

B TELECOM CONDUIT DETAIL

TELECOM DUCT INSTALLATION SPECIFICATIONS.

1. TOP OF CONDUIT SHALL BE PLACED NO LESS THAN 18-24" BELOW FINISHED GRADE
2. PLACE 6" WIDE YELLOW FIBER OPTIC CABLE WARNING TAPE NO GREATER THAN 5' BELOW FINISH GRADE
3. CONCRETE DUCT BANK CAPPING SHALL BE RED-PIGMENTED CONCRETE FOR LANDSCAPE-EXPOSED SECTIONS.
4. DEPTH OF CONCRETE CAP SHALL BE NO LESS THAN 15" BELOW FINISHED GRADE
5. LENGTH OF CONDUIT SHALL BE 3' MINIMUM BEYOND BUILDING CONDUCTOR ALONG LENGTH OF CONDUIT RUN AND ROUNDED BUILDING GROUND
6. ALL CONDUITS SHALL BE PLUGGED AND/OR CAPPED
7. IF MORE THAN (2) LARGE RADIIUS 90 DEGREE BENDS ARE REQUIRED, AN INTERMEDIATE PULL BOX IS REQUIRED
8. ALL BENDS SHALL MAINTAIN A MIN. 48" BEND RADIUS
9. WITH A BLOWER/VACUUM AND MEASURE EACH CONDUIT AND INNERDUCT
10. EACH 4" CONDUIT SHALL HAVE A 5/8" 1,800.PS TENSILE STRENGTH, PRELUBRICATED, FOOTAGE-MARKED POLYESTER PULL TAPE. EACH MULTI-GARD DUCT SHALL HAVE A 1/2", 1,250.PS TENSILE STRENGTH, PRELUBRICATED, FOOTAGE-MARKED POLYESTER PULL TAPE.
11. 3/4" AGGREGATE SHALL BE INSTALLED IN BOTTOM OF CONDUIT TRENCH, DUCTBANK
12. A METALLIC TRACER WIRE SHALL BE INSTALLED 6" - 8" BELOW GRADE.
13. ALL MULTI-GARD SUB-DUCTS SHALL BE PRE-LUBRICATED ACCORDING TO BELL CORE REQUIREMENTS.
14. ALL CONDUIT SHALL ENTER MANHOLE AT 90DEGREE ANGLES.

TELECOM DUCT SPECIFICATIONS.

1. ALL CONDUITS AND DUCT ACCESSORIES SHALL BE INSTALLED ACCORDING TO THE MANUFACTURERS RECOMMENDED INSTALLATION GUIDELINES.
2. ALL CONDUIT ACCESSORIES, AND COMPONENTS SHALL BE CARLON SCHEDULE 40 UL LISTED FOR UNDERGROUND USE WITH FIBER OPTICS AND COMMUNICATIONS CABLE.
3. ALL MULTI-GARD CONDUIT SHALL BE CARLON CMPS345-020 OR EQUIVALENT. ALL MULTI-GARD 4" CONDUIT SHALL BE CARLON CMPS345-020 OR EQUIVALENT.
5. ALL DUCTS SHALL BE RACKED WITHIN THE TRENCH.

TELECOM MANHOLE SPECIFICATIONS.

1. MANHOLE SPECIFICATION SHALL BE AN LUDCASTLE PRECAST DOUBLE LEAF 3'-0" WIDE x 5'-0" LONG x 3'-0" OR APPROVED APPROVED EQUAL. COVER SHALL BE HINGED. ALL KNOCKOUT SIZES AND CONFIGURATIONS SHALL BE COORDINATED WITH THE MANUFACTURER PRIOR TO ORDER
2. ALL CONDUIT KNOCK-OUTS AND VIDS AROUND CONDUITS SHALL BE SEALED POST CONDUIT INSTALLATION
3. ALL HANDHOLES TO BE INSTALLED WITH CABLE RACKING HARDWARE.
4. ALL CONDUIT ENTRANCES SHALL UTILIZE OLD CASTLE HDPE TERMINATORS OR APPROVED EQUAL.
5. HAND-HOLES SHALL BE INSTALLED LEVEL AND TOP ENTRANCE DODDS SHALL BE FLUSH WITH FINISHED GRADE.
6. ALL FINISHED GRADE TO BE INSTALLED ON OWNERS PROPERTY.
7. MANHOLES SHALL BE EQUIPPED WITH SUMP AND/OR DRAINAGE FIELD TO ELIMINATE STANDING WATER
8. ALL CONDUIT IN MANHOLE SHALL BE STOPPED AND SEALED

C TELECOM SITE PLAN NOTES

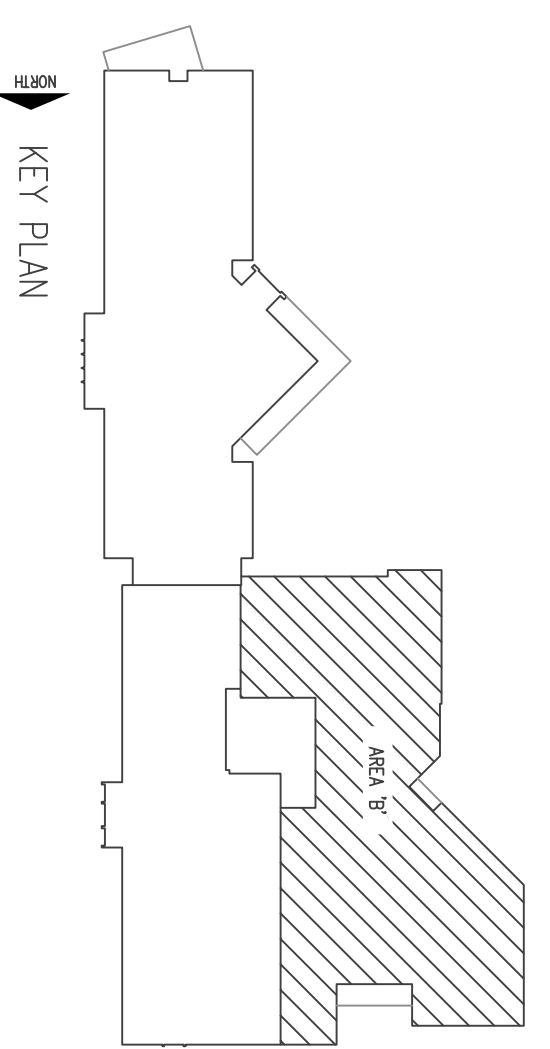

STRAVIS TECHNOLOGIES
 4506 East Parkway Suite 300
 Addison, TX 75201
 972.644.8822

EUBANKS•HARRIS ROBERTS• CRAIG ARCHITECTS, INC. www.eharc.com	
FOR CONSTRUCTION	
PROJECT NO. 2009-14	DATE: 02-23-2010
1510 E. GRANITE BLVD. TYLER, TX 75703	PHONE: 903-544-0995 FAX: 903-544-1071
RENOVATIONS & ADDITIONS	
BIRDWELL ELEMENTARY	
TYLER I.S.D.	
TYLER, TEXAS	
DRAWING: TECHNOLOGY SITE PLAN	SHEET NO.: 11.0
REVISION:	